

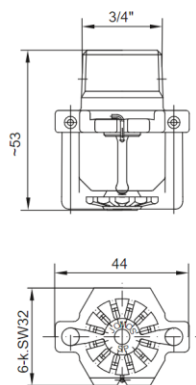

ELO-Sprinkler DN15- K160, Typ: EBSP (Stainless Steel)



— 0,5 bar
 - - - 1,0 bar
 - · - · 3,0 bar

Sprühradien

EBSP K160

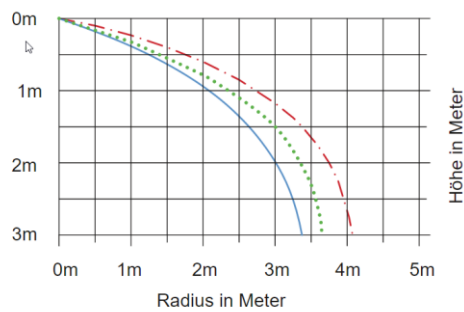

Technical Specs

Spray characteristics	Spray-Sprinkler SP, pendent	
Responsivity	Quick- Response	RTI- 035
	Standard- Response	RTI- 055
	Normal- Response	RTI- 105
Max. working pressure	PS 12.5 bar	
Min. working pressure	min. 0.35 bar	
Temperature range	57°C, 68°C, 79°C, 93°C, 141°C, 182°C, 260°C	
K- Factor	K- 160	

Material

Sprinkler body /Deflector	St 1.4401 / 1.4404
Button	St 1.4404
Sealing Assembly	Stainless steel / Teflon
Bulb	Borosilikatglass
Pins	St 1.4034

General Instructions

Do not install any bulb type sprinkler if the bulb is cracked or is a loss of liquid from the bulb. With the sprinkler held horizontally, a small air bubble should be present. The diameter of the air bubble is approximately 1,6mm for the 57° to 2,4mm for the 182° temperature ratings. A leak-tight 3/4 " NPT sprinkler joint should be obtained by applying a minimum to maximum torque of 10 to 14 Nm. Higher levels of torque may distort the sprinkler inlet and cause leakage or impairment of the sprinkler.

Installation Instruction

Before installation, the operator or planner must ensure that the component is suitable for the relevant environment and intended use

- Sprinkler shall only be installed by trained personal.
- Install sprinklers only with the special wrench foreseen for each sprinkler type.
- Install sprinklers only in fully installed and fixed pipe work.

- The threads (fitting / socket) must be clean, free of grease and burrs.

Never install a sprinkler that has had their packaging damaged.

Never install a sprinkler that has been dropped or has suffered any impact.

Always to align sprinklers turn clockwise only. Alignment on the opposite side can create leakage.

Warning

- Sprinklers containing in the original packing have been manufactured and tested according the requirements of the sprinkler authorities.
- Any modification to the sprinkler in the form of painting, warp of deflector, will seriously affect the operation. This will lead to withdraw of insurances approval and any guarantee to JOMOS EuroSprinkler AG
- Stainless steel sprinklers may only be used if the planner / operator has ensured that they are suitable for the application.

Sprinkler marking

RTI- value	Q = RTI- 035, S = RTI- 055, N = RTI- 105
Week of manufacturing	35 = Week 35
Year of manufacturing	09 = Year 2009
Temperature range	57°C, 68°C , 79°C, 93°C, 141°C, 182°C, 260°C
Sprinkler size	EB = ½" K- 160, EC = ¾" K- 160
K- Factor	K- 57, K- 80, K- 115, K- 160
Certificated at	Vds

