

ELO- Spray-Sprinkler DN15- K160, Type: EBSU

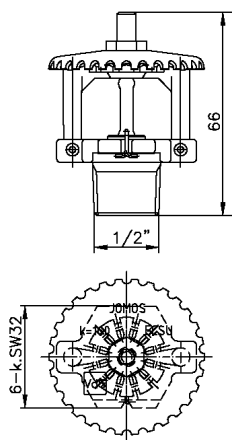

Sprühradien

EBSU
K=160

— 0.5 bar
- - - 1.0 bar
- · - · 3.0 bar

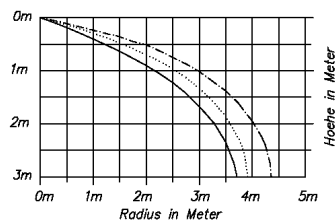

Technical Dates

Spray characteristics	ELO- Spray-Sprinkler SU, upright
Responsivity	Quick- Response RTI- 035 Standard- Response RTI- 055 Normal- Response RTI- 105
Max. working pressure	PS 12.5
Min. working pressure	min. 0.35 bar
Temperature range	57°C, 68°C, 79°C, 93°C, 141°C, 182°C, 260°C
K- Factor	K- 160

Material / Coatings

Sprinklerbody /Deflector	roh = Brass gc = Chrome plated / Ral = color coated
Button	Brass
Sealing Assembly	Stainless steel / Teflon
Bulb	Borosilikatglass
Pins	Stainless steel

General Instructions

Do not install any bulb type sprinkler if the bulb is cracked or is a loss of liquid from the bulb. With the sprinkler held horizontally, a small air bubble should be present. The diameter of the air bubble is approximately 1,6mm for the 57° to 2,4mm for the 182° temperature ratings. A leak-tight 3/4 " NPT sprinkler joint should be obtained by applying a minimum to maximum torque of 10 to 14 Nm. Higher levels of torque may distort the sprinkler inlet and cause leakage or impairment of the sprinkler.

Installation Instruction

- Sprinkler may only installed by trained personal.
- Install sprinklers only with the special wrench foreseen for each sprinkler type.
- Install sprinklers only in fully installed and fixed pipe work.
- The threads (fitting / socket) must be clean, free of grease and burrs.

Never install a sprinkler that has had their packaging damaged.

Never install a sprinkler that has been dropped or has suffered any impact.

Always to align sprinklers turn clockwise only. Alignment on the opposite side can create leakage.

Warning

- Sprinklers containing in the original packing have been manufactured and tested according the requirements of the sprinkler authorities.
- Any modification to the sprinkler in the form of painting, warp of deflector, will seriously affect the operation. This will lead to withdraw of insurances approval and any guarantee to JOMOS EuroSprinkler AG
- Sprinklers (brass and chrome plated) may only install in normal atmosphere. For areas with aggressive, corrosive atmosphere ore in case of leakage current, use sprinklers with special coating or stainless steel sprinklers.

Sprinkler marking

RTI- value	Q = RTI- 035, S = RTI- 055, N = RTI- 105
Week of manufacturing	35 = Week 35
Year of manufacturing	09 = Year 2009
Temperature range	57°C, 68°C , 79°C, 93°C, 141°C, 182°C, 260°C
Sprinkler size	EB = 1/2" K- 160, EC = 3/4" K- 160
K- Factor	K- 57, K- 80, K- 115, K- 160
Certificated at	Vds

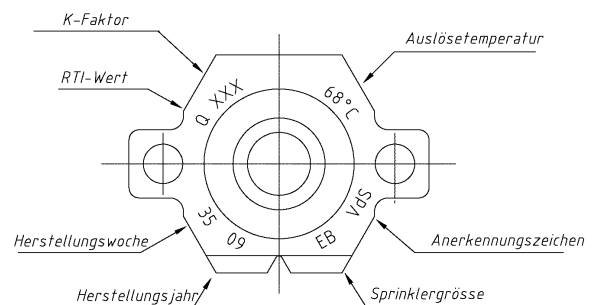

Bezeichnung	roh= Brass	mc=matt chrome plated	gc= chrome plated	Ral = colour coated
EBSU 1/2" 57°C RTI- 035	Art. Nr. 715 500	Art. Nr. 715 501	Art. Nr. 715 502	Art. Nr. 715 503
EBSU 1/2" 68°C RTI- 035	Art. Nr. 715 510	Art. Nr. 715 511	Art. Nr. 715 512	Art. Nr. 715 513
EBSU 1/2" 79°C RTI- 035	Art. Nr. 715 520	Art. Nr. 715 521	Art. Nr. 715 522	Art. Nr. 715 523
EBSU 1/2" 93°C RTI- 035	Art. Nr. 715 530	Art. Nr. 715 531	Art. Nr. 715 532	Art. Nr. 715 533
EBSU 1/2" 141°C RTI- 035	Art. Nr. 715 540	Art. Nr. 715 541	Art. Nr. 715 542	Art. Nr. 715 543
Vds- Nr. G 4060020				
EBSU 1/2" 57°C RTI- 055	Art. Nr. 715 570	Art. Nr. 715 571	Art. Nr. 715 572	Art. Nr. 715 573
EBSU 1/2" 68°C RTI- 055	Art. Nr. 715 580	Art. Nr. 715 581	Art. Nr. 715 582	Art. Nr. 715 583
EBSU 1/2" 79°C RTI- 055	Art. Nr. 715 590	Art. Nr. 715 591	Art. Nr. 715 592	Art. Nr. 715 593
EBSU 1/2" 93°C RTI- 055	Art. Nr. 715 600	Art. Nr. 715 601	Art. Nr. 715 602	Art. Nr. 715 603
EBSU 1/2" 141°C RTI- 055	Art. Nr. 715 610	Art. Nr. 715 611	Art. Nr. 715 612	Art. Nr. 715 613
EBSU 1/2" 182°C RTI- 055	Art. Nr. 715 620	Art. Nr. 715 621	Art. Nr. 715 622	Art. Nr. 715 623
EBSU 1/2" 260°C RTI- 055	Art. Nr. 715 625	Art. Nr. 715 626	Art. Nr. 715 627	Art. Nr. 715 628
Vds- Nr. G 4060022				
EBSU 1/2" 57°C RTI- 105	Art. Nr. 715 630	Art. Nr. 715 631	Art. Nr. 715 632	Art. Nr. 715 633
EBSU 1/2" 68°C RTI- 105	Art. Nr. 715 640	Art. Nr. 715 641	Art. Nr. 715 642	Art. Nr. 715 643
EBSU 1/2" 79°C RTI- 105	Art. Nr. 715 650	Art. Nr. 715 651	Art. Nr. 715 652	Art. Nr. 715 653
EBSU 1/2" 93°C RTI- 105	Art. Nr. 715 660	Art. Nr. 715 661	Art. Nr. 715 662	Art. Nr. 715 663
EBSU 1/2" 141°C RTI- 105	Art. Nr. 715 670	Art. Nr. 715 671	Art. Nr. 715 672	Art. Nr. 715 673
EBSU 1/2" 182°C RTI- 105	Art. Nr. 715 680	Art. Nr. 715 681	Art. Nr. 715 682	Art. Nr. 715 683
EBSU 1/2" 260°C RTI- 105	Art. Nr. 715 685	Art. Nr. 715 686	Art. Nr. 715 687	Art. Nr. 715 688
Vds- Nr. G 4060024				